

CORNER GUARDS

These stainless steel corner protectors are typically used to protect your cases, fixtures, and high traffic passage ways.

Case protectors will withstand impacts up to 4000 pounds from floor scrubbers, pallet jacks, etc.

Custom Colors Available

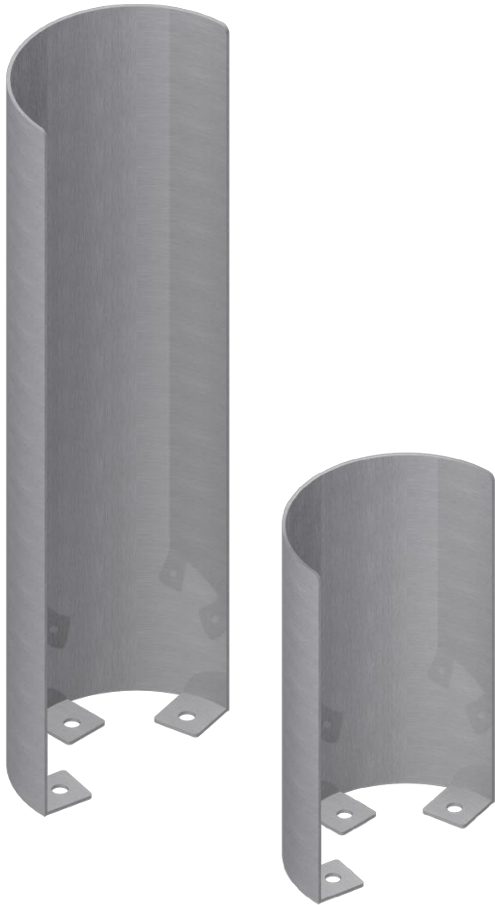

5050003 and 5050002
Shown From Left



5050004
Base is core drilled into floor and top is removable for easy floor cleaning

FEATURES:

High quality stainless steel corner guards will not chip or rust under any conditions

HEAVY DUTY 12 gauge 304 stainless steel Construction

Brushed stainless steel finish enhances the appearance of your store

Comes with expandable anchors for fast and easy installation that is unexposed

5050004 only:

Tubular case guards are core drilled into floor with male and female connection

Sleek removable design allows posts to be removed for cleaning of store floors



NATIONAL CART CO

1-800-455-3802
nationalcart.com



Freight Class: 70
NMFC Code: 95190

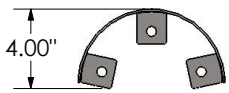

5050002

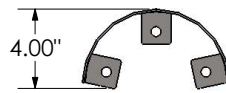
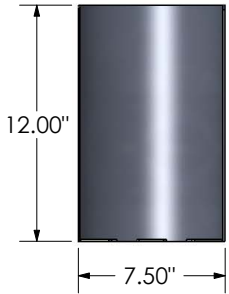

5050003

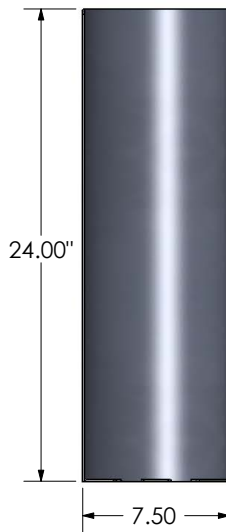

5050004

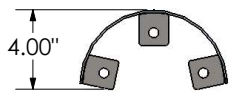
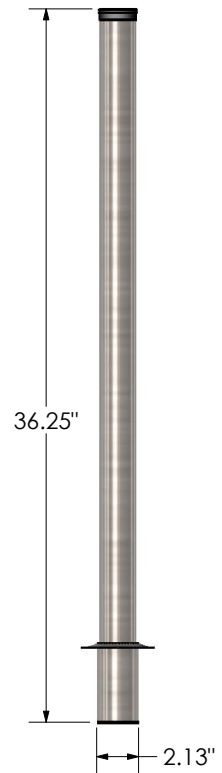

5050008

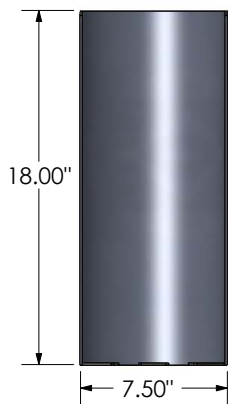

Order #	Model	W	D	H	Weight
5050002	SSCG-12RD, 7.250 DIA. x 12 TALL	7 1/2"	4"	12"	9 lbs.
5050003	SSCG-24RD, 7.250 DIA. x 24 TALL	7 1/2"	4"	24"	17 lbs.
5050008	SSCG-18RD, 7-1/4 DIA. X 18 TALL	7 1/2"	4"	18"	14 lbs.
5050004	SSCG-POST, 2.0 DIA x 36.063 TALL	2 1/8"	2 1/8"	36 1/4"	8 lbs.

Can't find exactly what you need? Give us a call and we'll help you with the perfect solution!